

HI 20

THE VARIABLE LIGHTING SOLUTION.



When it comes to the HI 20, diversity not only means that it is available with various angles of illumination. In conjunction with the flexible tube, it can easily be brought into the right position in tight spaces. Its extra strong halogen lamp can thus light up every angle.

- Versatile halogen luminaire
- Brilliant halogen light
- Variants with narrow and wide angles of illumination
- Easy and fast positioning
- Bright
- Heat protection jacket
- Easy, tool-free changing of lamp
- Convenient switching on and off from your working position
- High life cycle of the lamp



Features at a glance

- Halogen lamp
- Color temperature warm white 2,800 K (23 W) or 3,000 K (20 W)
- 10°, 24°, 36° or 60° angle of illumination
- Black luminaire head of aluminum and plastic, glass screen
- Metal flexible tube for at least 20,000 movements
- With switch in the luminaire head
- System of protection IP20; class of protection III (without transformer) or II (with transformer)
- Supplied with 1.5 m mains lead with free stranded wires or Euro plug (230 V)
- Various fastenings and magnifier (4 diopters) as accessories



HI 20 with integrated transformer

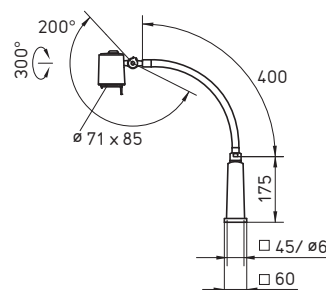

HI 20 without transformer

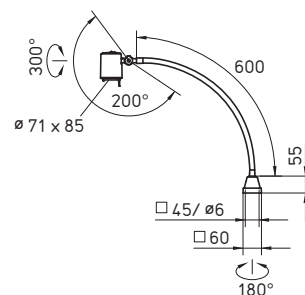

Integrated machine luminaires



Surface-mounted luminaires



Tube luminaires



Arm-mounted luminaires

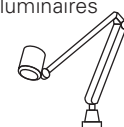

Flexible-tube luminaires

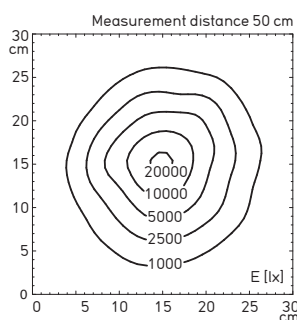
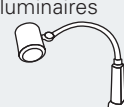

Illuminance with 10° angle of illumination (order no: 112 378 000)

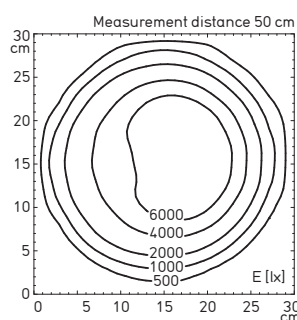

Illuminance with 24° angle of illumination (order no: 112 378 001)

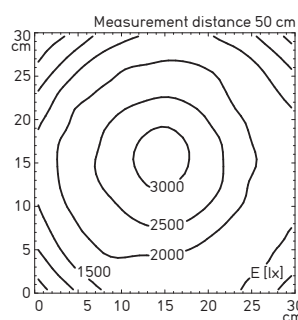

Illuminance with 36° angle of illumination (order no: 112 378 002)

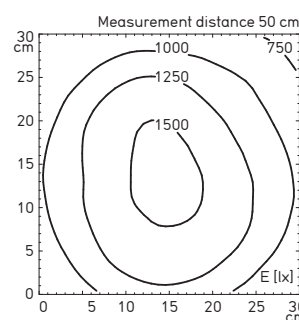

Illuminance with 60° angle of illumination (order no: 112 378 003)

FITTED WITH	OPERATING DEVICE	CONNECTED LOAD	SPECIAL FEATURE	E_m / E_{max}^*	MODEL	ORDER NO.
1 x 20 W	Integrated transformer	230 V, 50/60 Hz	10° angle of illumination	2268/23200 lx ¹	HITH 20 N	112 378 000 - 000 608 54
1 x 20 W	Integrated transformer	230 V, 50/60 Hz	24° angle of illumination	2504/7375 lx ¹	HITH 20 N	112 378 001 - 000 683 32
1 x 20 W	Integrated transformer	230 V, 50/60 Hz	36° angle of illumination	1970/3126 lx ¹	HITH 20 N	112 378 002 - 000 683 34
1 x 20 W	Integrated transformer	230 V, 50/60 Hz	60° angle of illumination	1182/1598 lx ¹	HITH 20 N	112 378 003 - 000 683 39
1 x 20 W	–	12 VAC/DC	24° angle of illumination	2504/7375 lx ¹	HITF 20 S	112 379 025 - 000 684 01
1 x 23 W	–	24 VAC/DC	10° angle of illumination	1619/14398 lx ¹	HITF 20 S	112 379 028 - 000 609 06
1 x 23 W	–	24 VAC/DC	24° angle of illumination	1683/7082 lx ¹	HITF 20 S	112 379 029 - 000 903 37
1 x 23 W	–	24 VAC/DC	36° angle of illumination	1553/3055 lx ¹	HITF 20 S	112 379 030 - 000 903 39

* E_m = medium illuminance; E_{max} = maximum illuminance; ¹ Measuring range 30 cm x 30 cm / Measuring distance 50 cm

Also available as an arm-mounted and pivoting-head luminaire